

EN **INSTALLATION MANUAL LOWER HALF DOOR INSERT**

DE **MONTAGEANLEITUNG TÜRNSET**

RU **ИНСТРУКЦИЯ ПО УСТАНОВКЕ НИЖНИХ ПАНЕЛЕЙ ДВЕРЕЙ**



For: Polaris RZR XP 1000 (2014-)

2444.7447.1



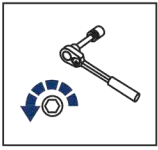

EN Regular fasteners
DE Originale montageteile
RU Штатный крепеж

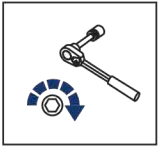

EN Regular fasteners
DE Originale montageteile
RU Штатный крепеж



EN Screw a several turns
DE Für wenigen Umdrehungen befestigen
RU Вкрутить на несколько оборотов

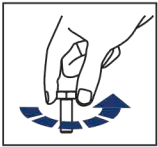

EN Loosen bolts
DE Bolzen lockern
RU Выкрутить на несколько оборотов

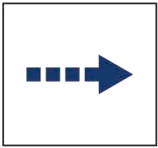

EN Movement Arrow
DE Bewegungsrichtung
RU Движение

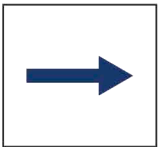

EN Location/Position Arrow
DE Anordnung/Positionsrichtung
RU Расположение



EN Screw Arrow
DE Drehungsrichtung
RU Поворот

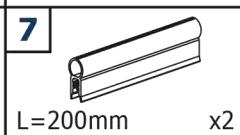
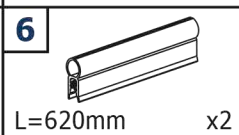
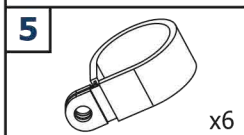
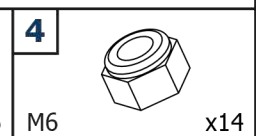
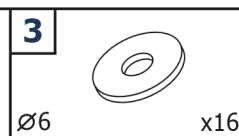
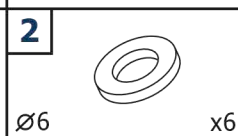
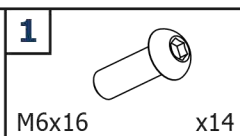
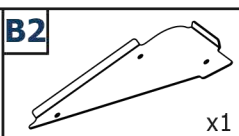
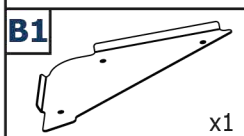
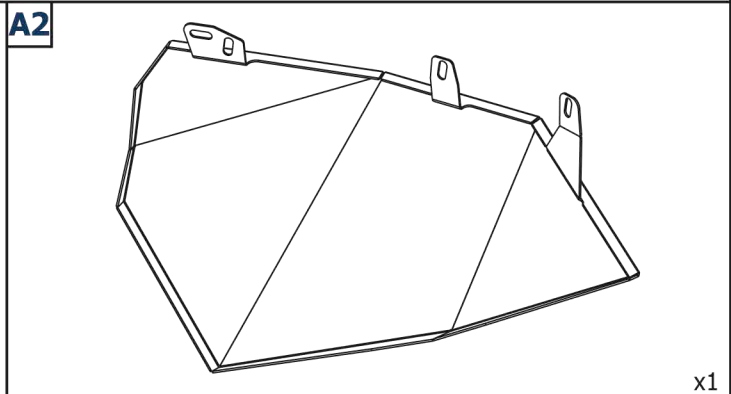
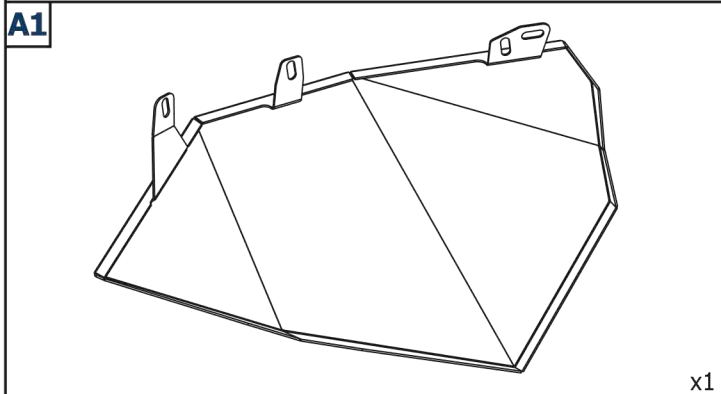
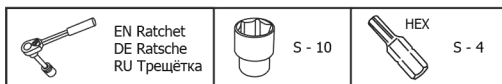

PRE-INSTALLATION: LAY OUT COMPONENTS AND COMPARE TO LIST AND IMAGES. IMAGES MAY NOT PORTRAY THE FULL DETAIL OR EXACT SHAPE OF THE PARTS; HOWEVER, THEY REPRESENT PARTS THAT HAVE SAME OR SIMILAR FUNCTION.

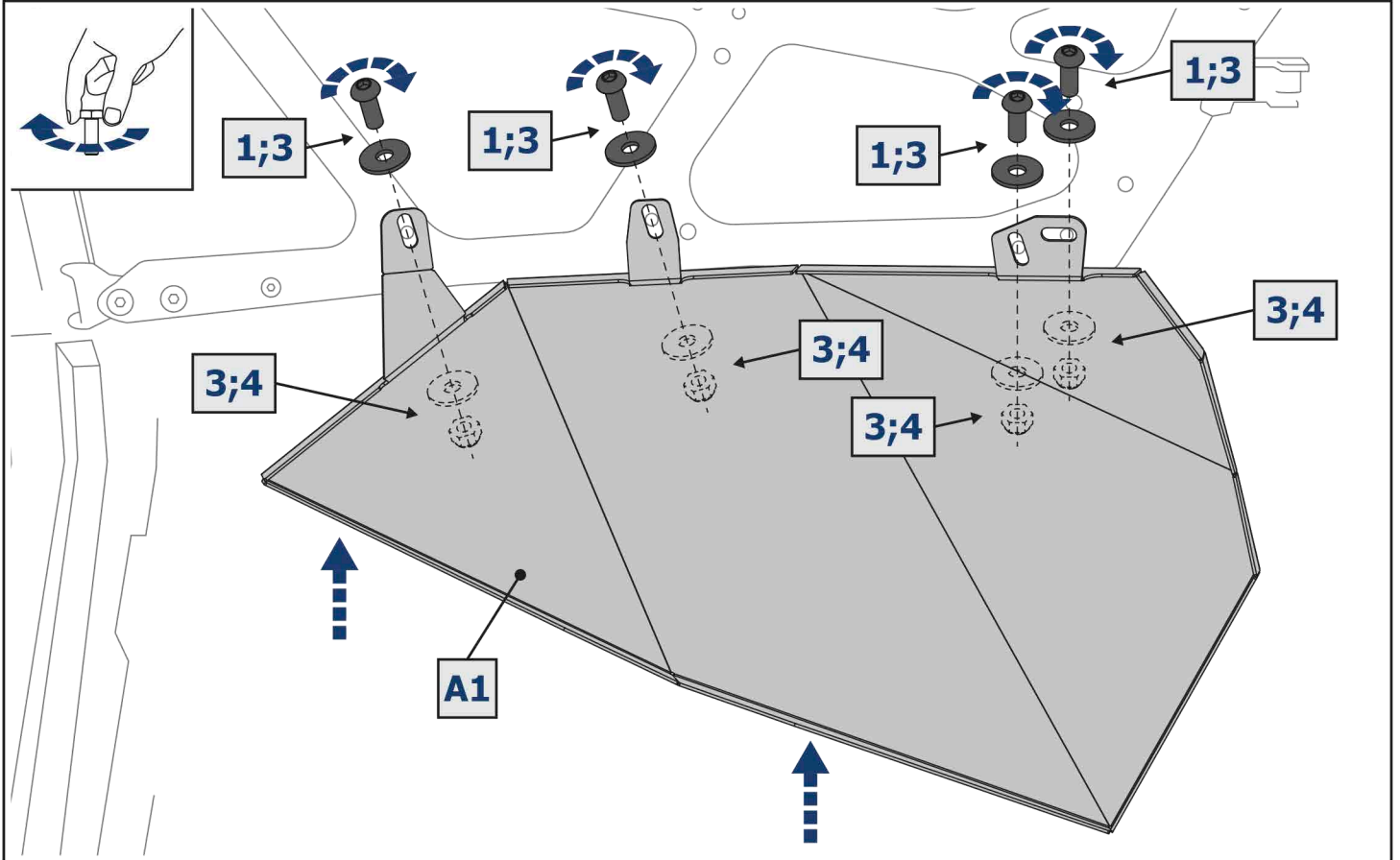
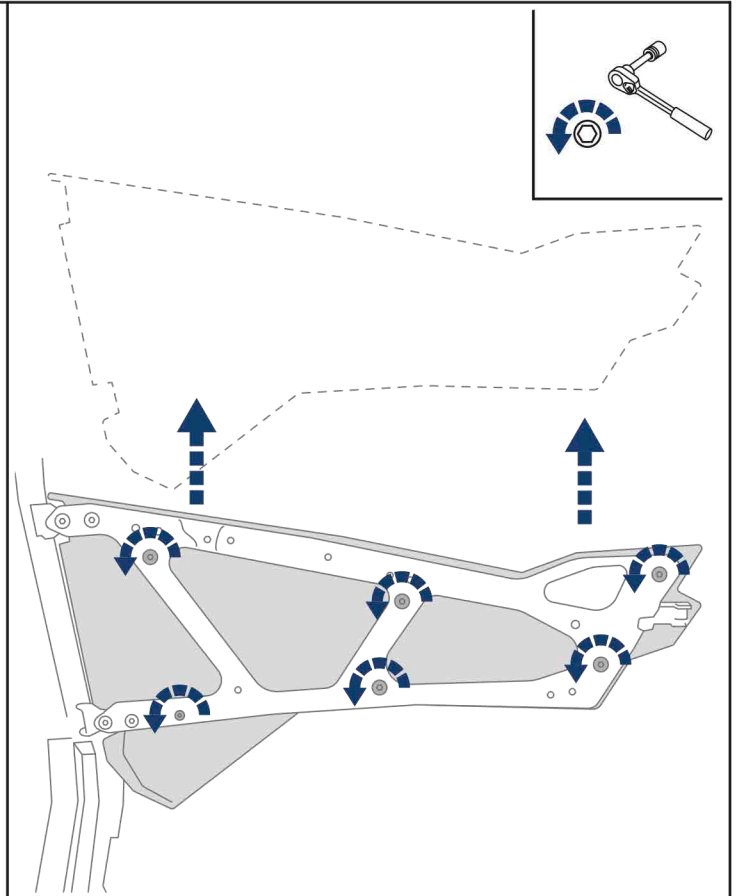

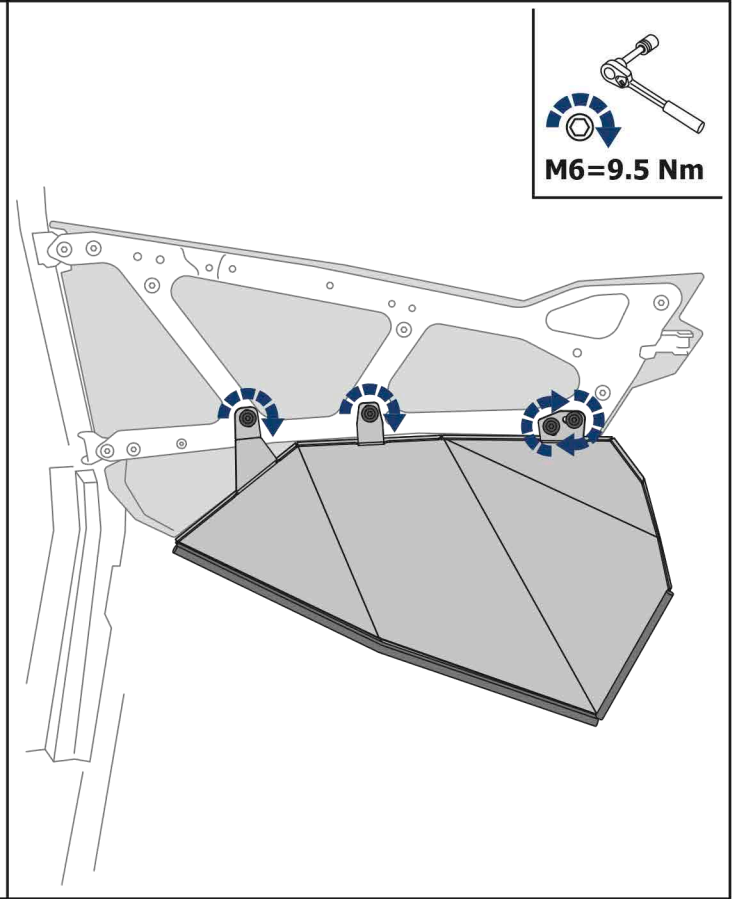
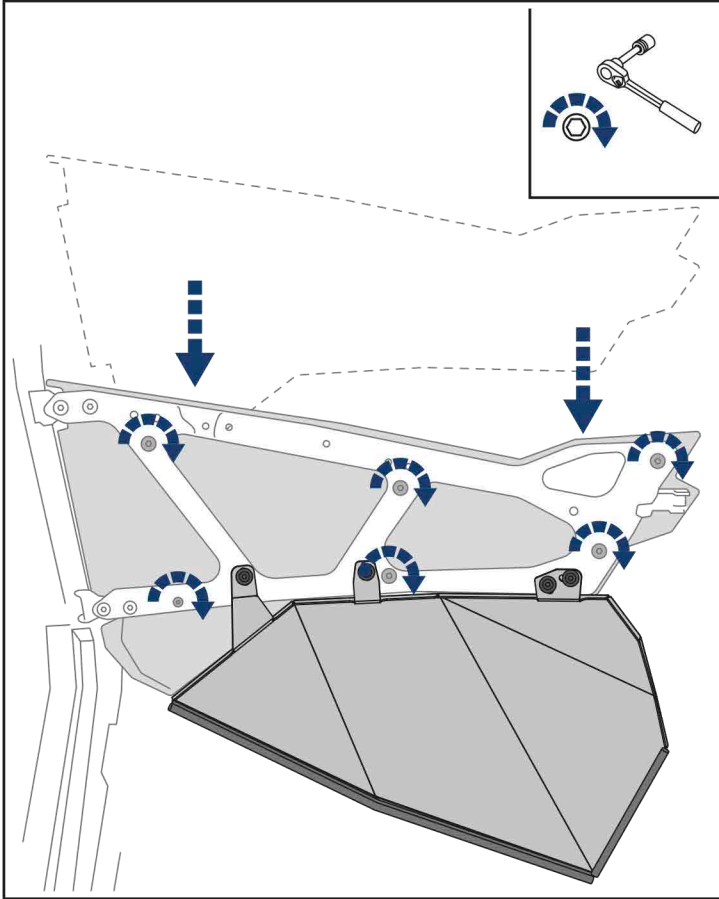
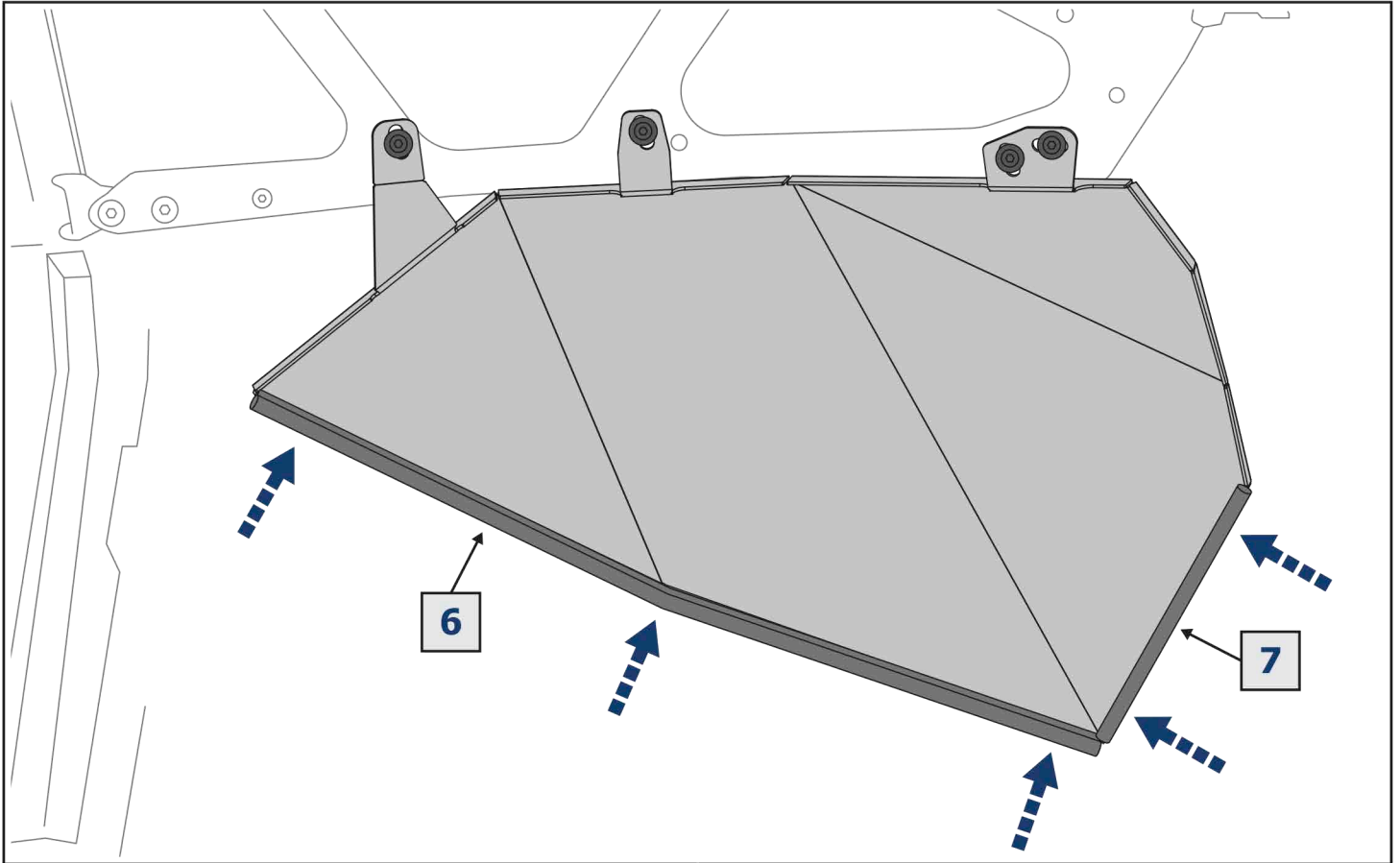

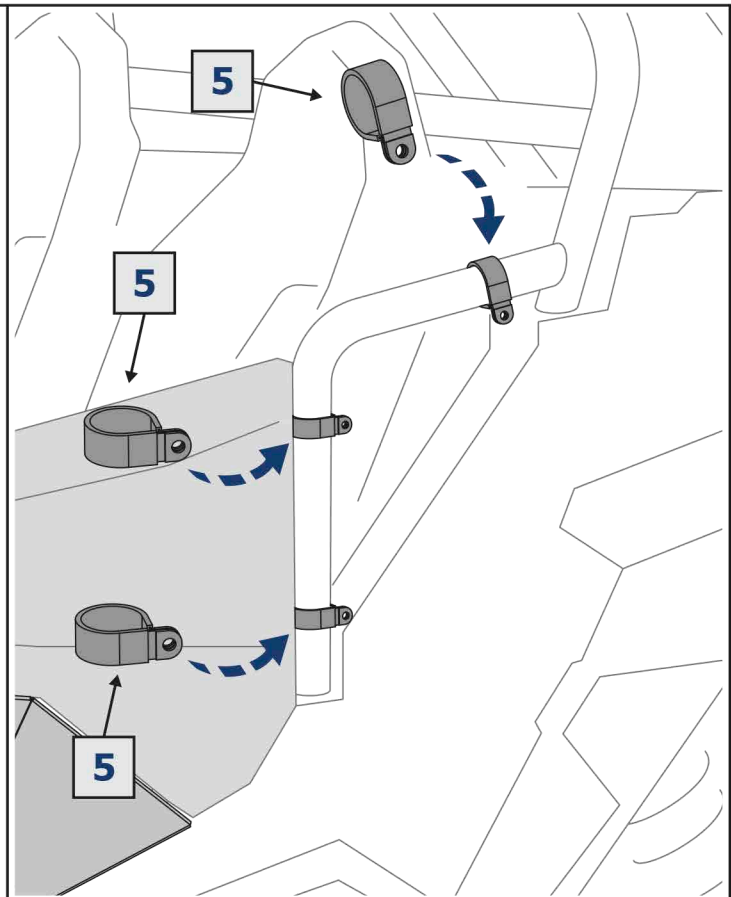
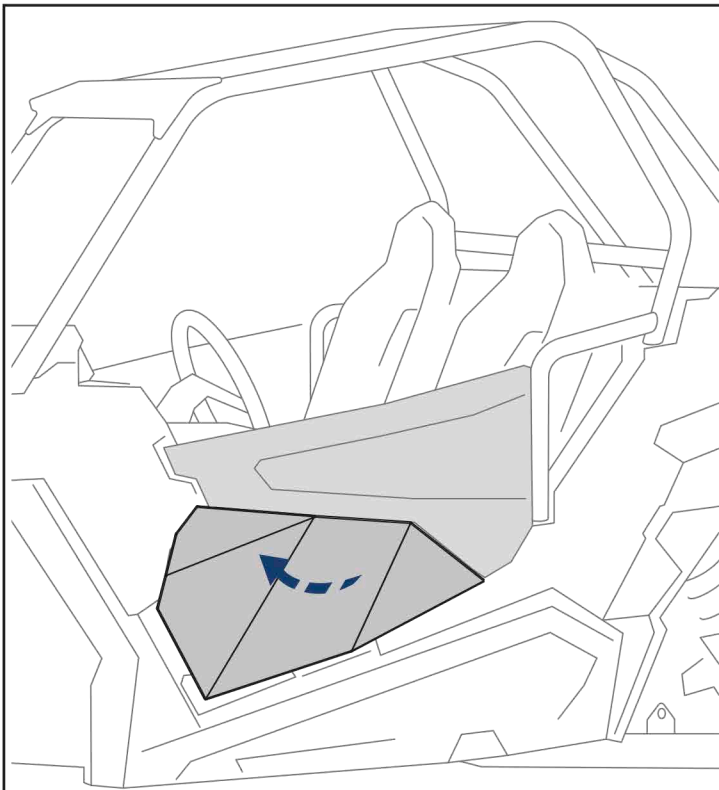

LEFT = RIGHT

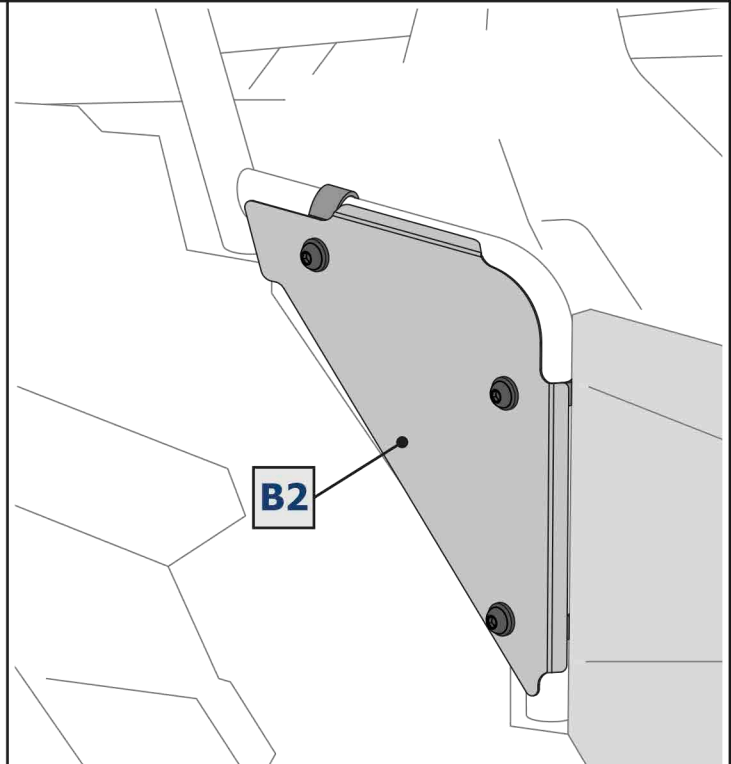
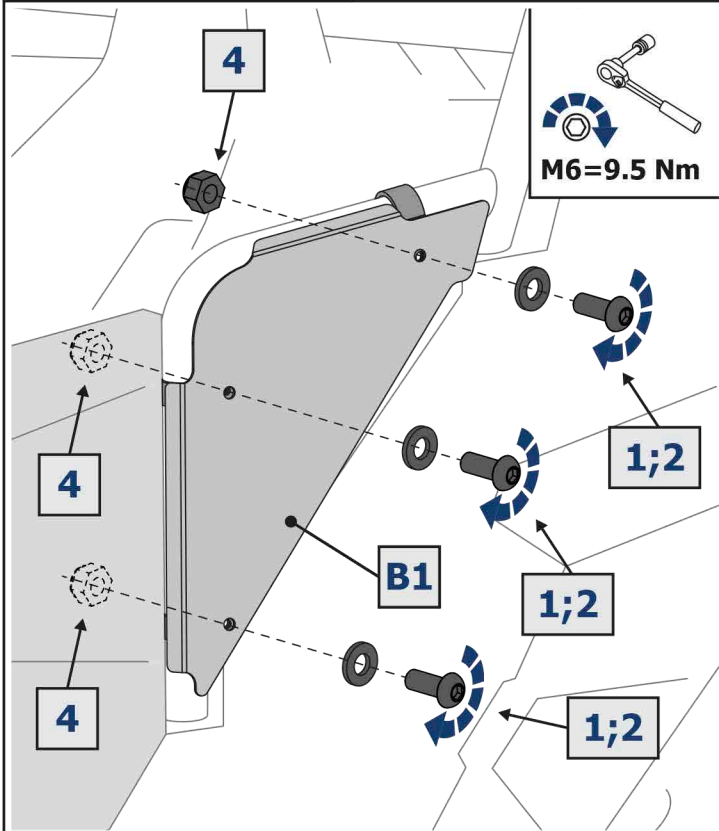

LEFT = RIGHT

TIP: PERIODICALLY CHECK ALL HARDWARE AND RE-TIGHTEN IF NEEDED.