

EN SKID PLATE INSTALLATION MANUAL

DE MONTAGEEINLEITUNG FÜR UNTERBODENSCHUTZSYSTEM



For: Defender HD10/ MAX HD10/ 6X6/ PRO (2020-)

2444.7286.1;



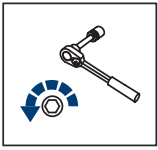

EN Regular fasteners
DE Originale montageile

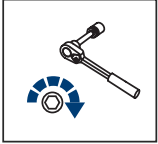

EN Regular fasteners
DE Originale montageile

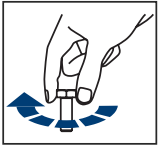

EN Screw a several turns
DE Für wenigen Umdrehungen befestigen

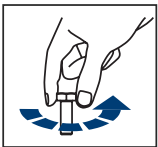

EN Loosen bolts
DE Bolzen lockern

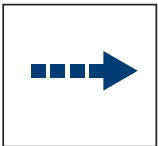

EN Movement Arrow
DE Bewegungsrichtung

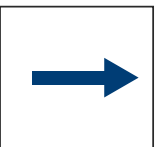



EN Location/Position Arrow
DE Anordnung/Positionsrichtung

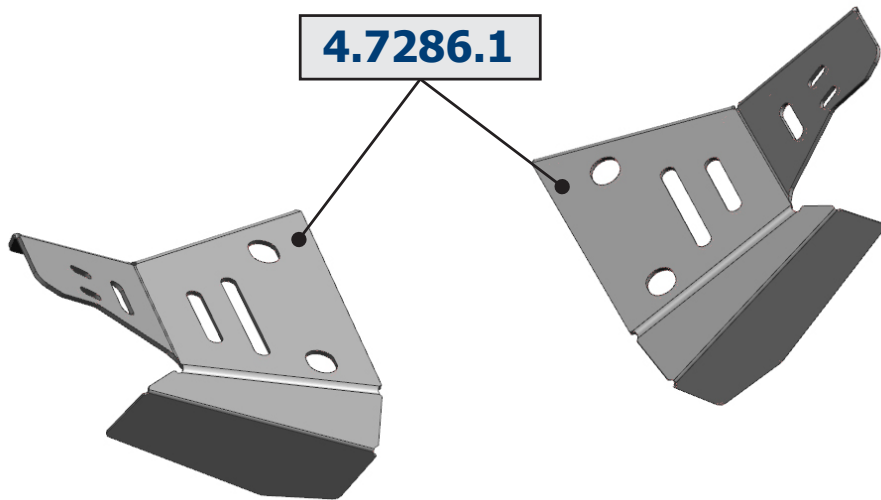
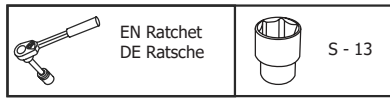

EN Screw Arrow
DE Drehungsrichtung

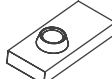
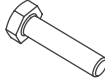
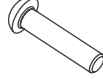

<p>1</p>  <p>M8x30/10 x8</p>	<p>2</p>  <p>M8x25 x4</p>	<p>3</p>  <p>M8x25 x4</p>	<p>4</p>  <p>Ø8 x4</p>	<p>5</p>  <p>Ø8 x4</p>
---	--	--	---	---

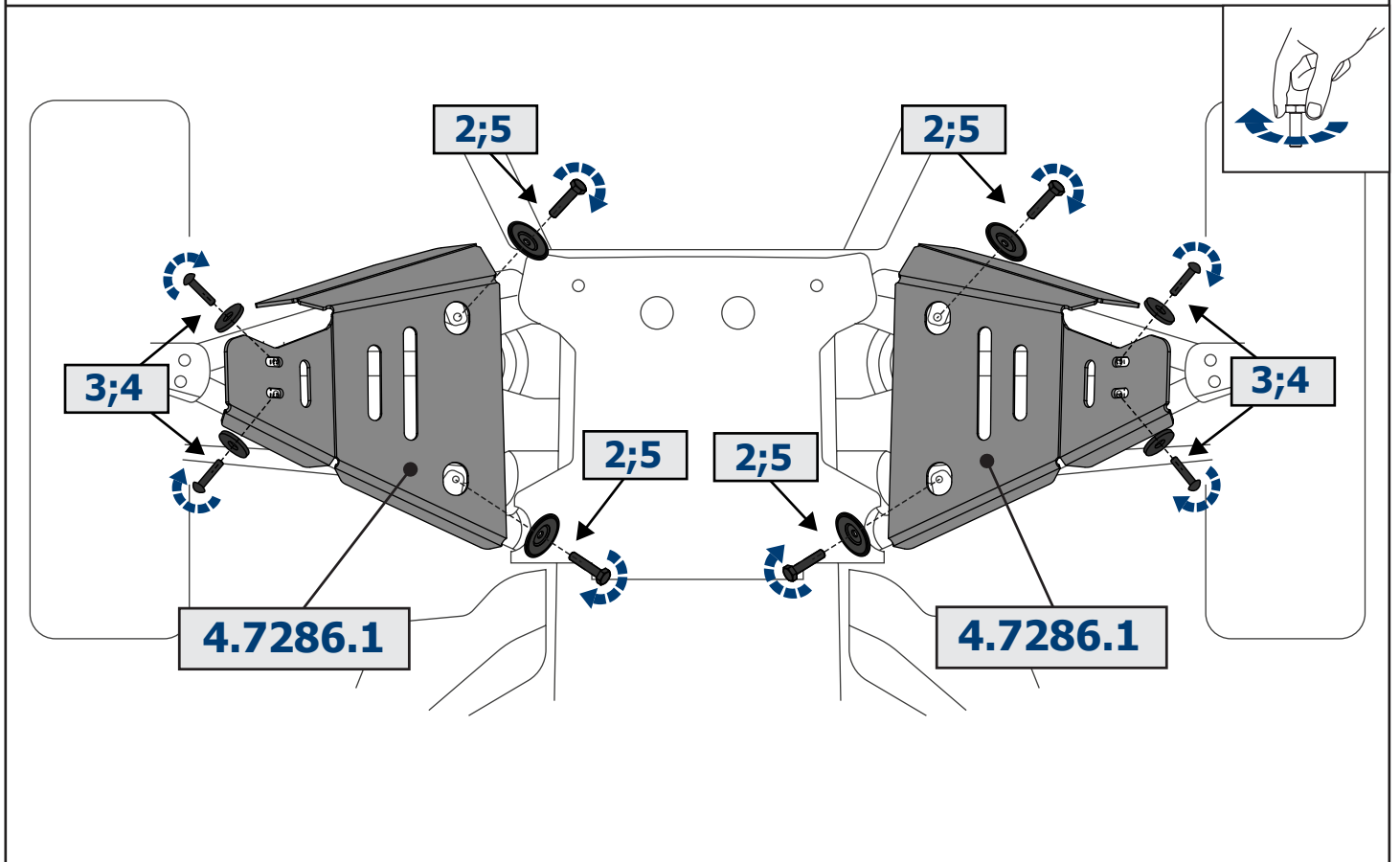
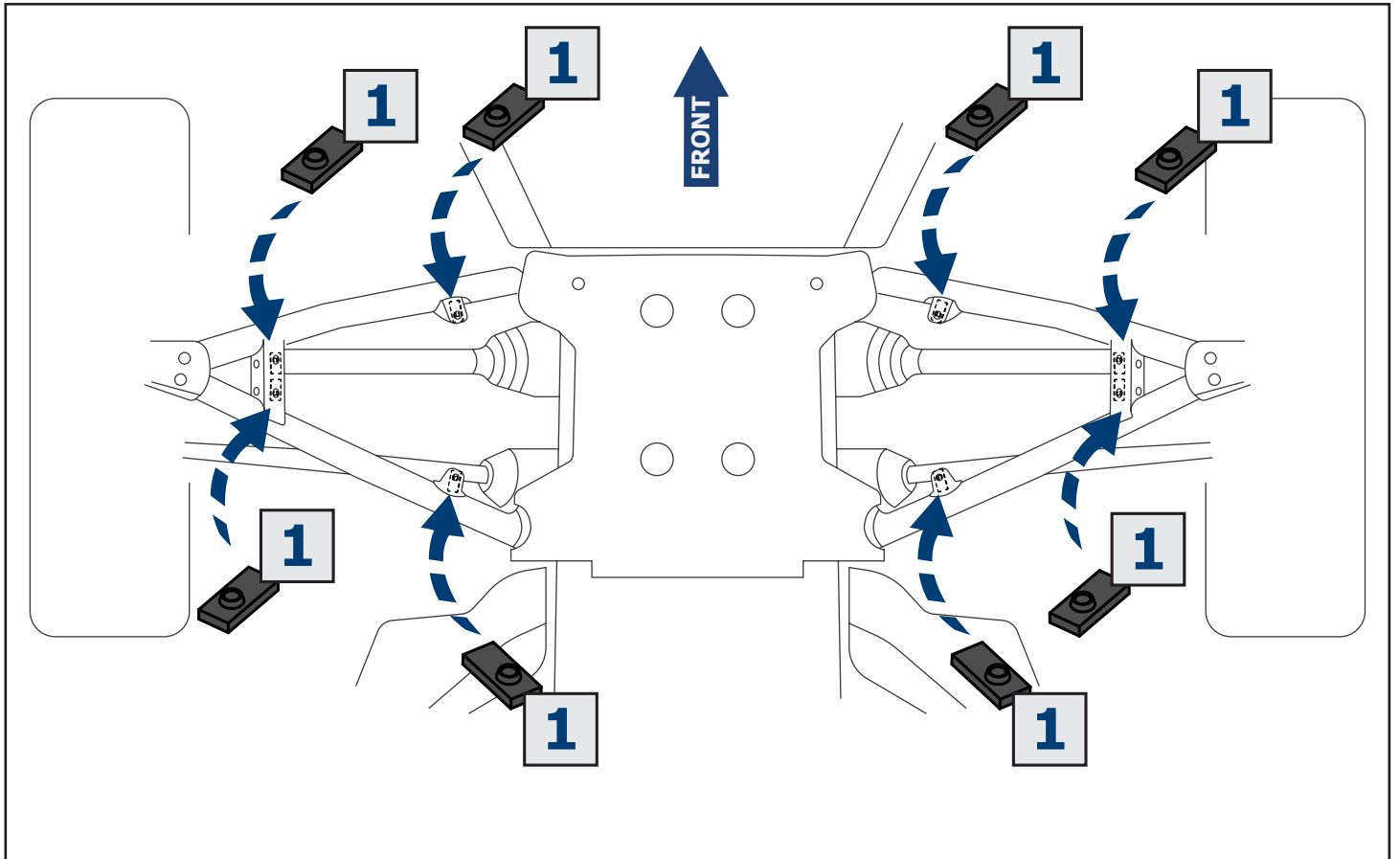

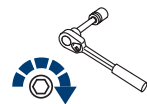

M8=30 Nm

