

EN SKID PLATE INSTALLATION MANUAL

DE MONTAGEEINLEITUNG FÜR UNTERBODENSCHUTZSYSTEM



For: Can-Am Defender / Defender MAX (2020-2022)

2444.7283.1



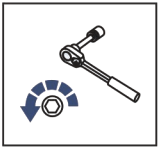

EN Regular fasteners
DE Originale montageile

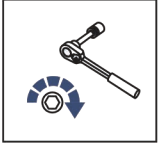

EN Regular fasteners
DE Originale montageile

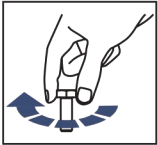

EN Screw a several turns
DE Für wenigen Umdrehungen befestigen

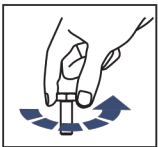

EN Loosen bolts
DE Bolzen lockern



EN Movement Arrow
DE Bewegungsrichtung

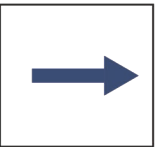

EN Location/Position Arrow
DE Anordnung/Positionsrichtung



EN Screw Arrow
DE Drehungsrichtung

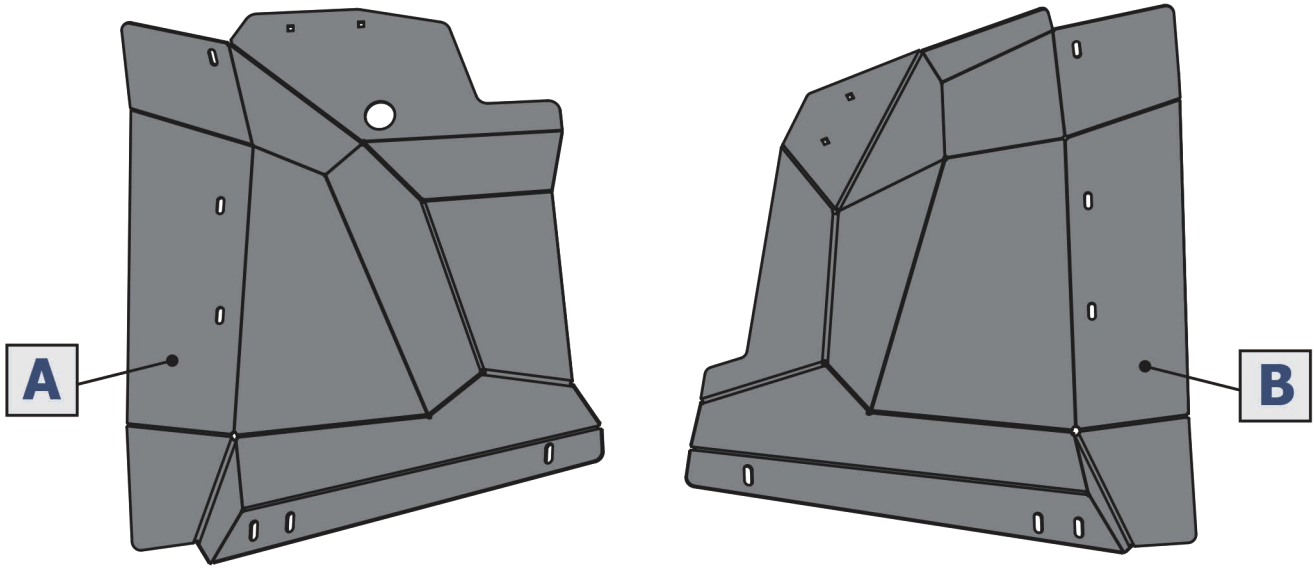
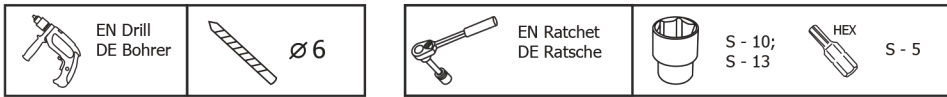

1 M6x25 x2	2 M6x25 x6	3 M8x70 x6	4 M6 x6	5 M8 x6	6 Ø6 x12
7 Ø8 x12					

