

EN **SKID PLATE INSTALLATION MANUAL**

DE **MONTAGEEINLEITUNG FÜR UNTERBODENSCHUTZSYSTEM**



For: Yamaha Wolverine X2 (2019-2022)

2444.7176.1



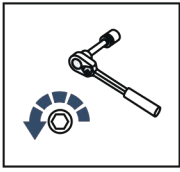

EN Regular fasteners
DE Originale montageteile

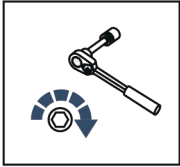

EN Regular fasteners
DE Originale montageteile

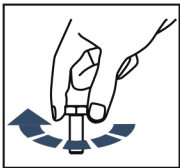

EN Screw a several turns
DE Für wenigen Umdrehungen befestigen

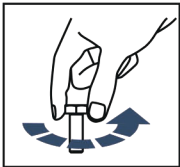

EN Loosen bolts
DE Bolzen lockern

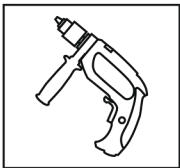

EN Drill
DE Bohrer

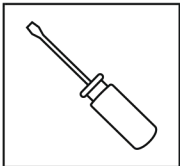

EN Screwdriver
DE Schraubenzieher

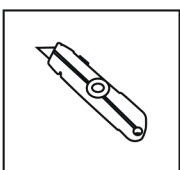



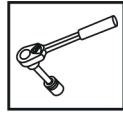
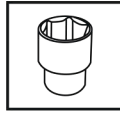
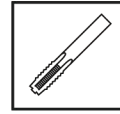

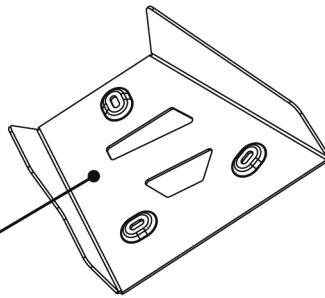
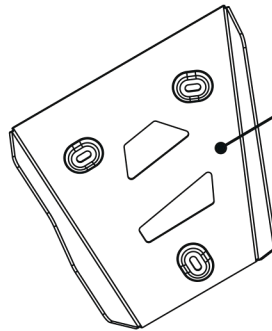

EN Office Knife
DE Büromesser

 EN Ratchet
 DE Ratsche

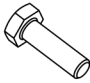
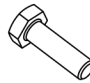
 S - 10;
 S - 13

M6

A2

A1

1  x2	2  x2	3  M6x25 x2	4  M8x25 x4	5  Ø6 x2	6  Ø8 x6
7  x2					

