

EN FRONT CV CUARDS INSTALLATION MANUAL

DE MONTAGEEINLEITUNG FÜR UNTERBODENSCHUTZSYSTEM



**For: Yamaha Wolverine RMAX 1000 (2021- )**

2444.7167.1



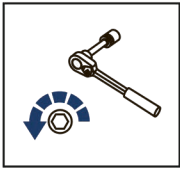

EN Regular fasteners  
DE Originale montageteile

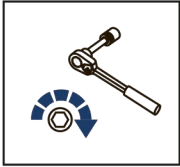

EN Regular fasteners  
DE Originale montageteile

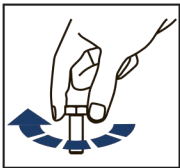

EN Screw a several turns  
DE Für wenigen Umdrehungen befestigen



EN Loosen bolts  
DE Bolzen lockern

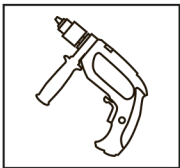

EN Drill  
DE Bohrer

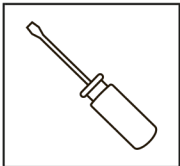

EN Screwdriver  
DE Schraubenzieher

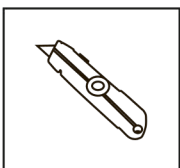

EN Office Knife  
DE Büromesser

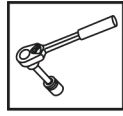

EN Ratchet

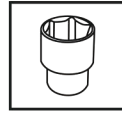

S - 10

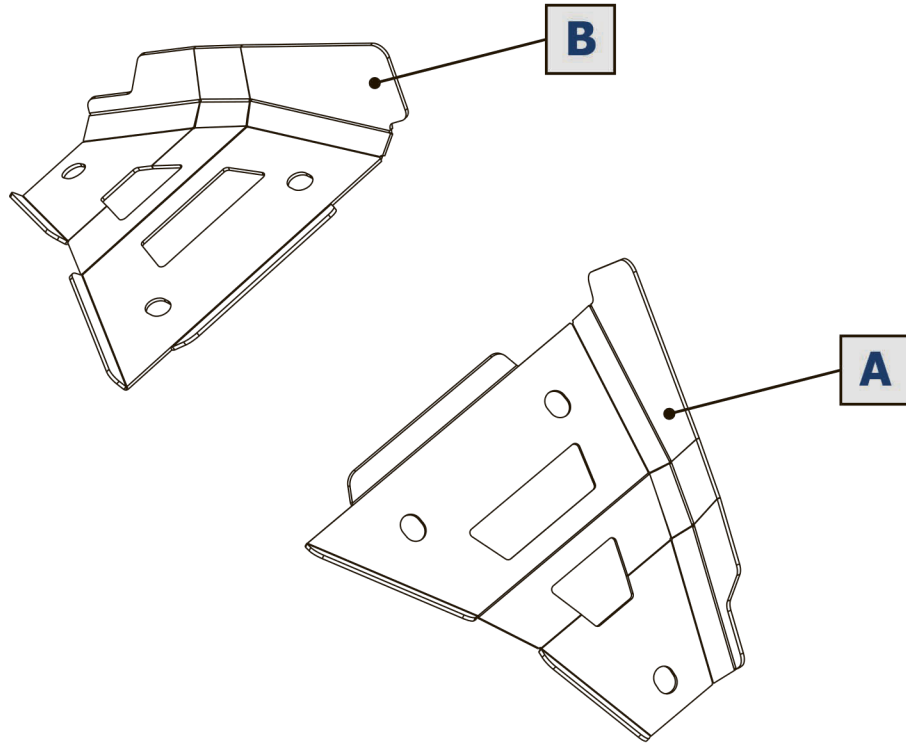

<p><b>1</b></p>  <p>Ø6 x6</p>	<p><b>2</b></p>  <p>M6x20 x2</p>	<p><b>3</b></p>  <p>M6x35 x4</p>			
--	---	---	--	--	--

