

EN

## SKID PLATE INSTALLATION MANUAL

DE

## MONTAGEEINLEITUNG FÜR UNTERBODENSCHUTZSYSTEM



**For: Yamaha Kodiak 450/4x4 (2017- )**

2444.7153.1-4



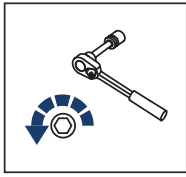

EN Regular fasteners  
DE Schraube herausdrehen

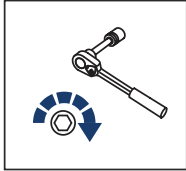

EN Regular fasteners  
DE Schraube eindrehen und festziehen

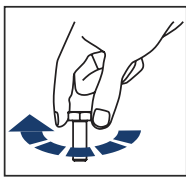

EN Screw a several turns  
DE Schraube wenige Umdrehungen eindrehen

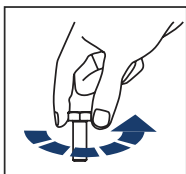

EN Loosen bolts  
DE Schraube wenige Umdrehungen lösen

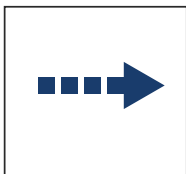

EN Movement Arrow  
DE Bewegungsrichtung

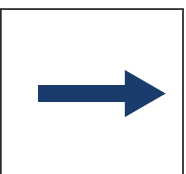



EN Location/Position Arrow  
DE Blickrichtung / Postionsrichtung

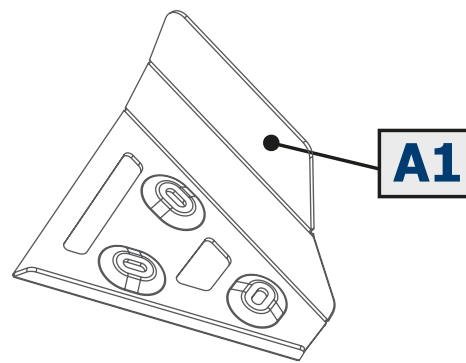
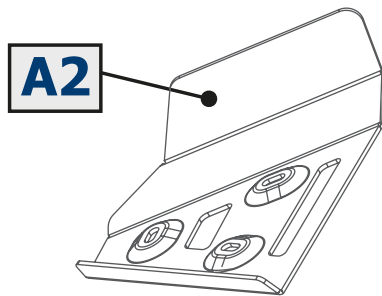
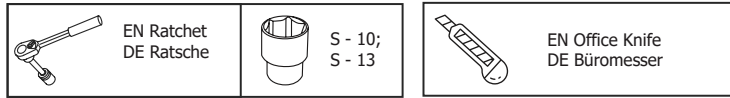

EN Screw Arrow  
DE Drehrichtung

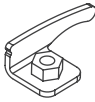
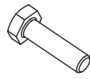
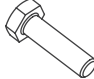

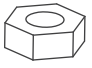
<p><b>1</b></p>  <p>x2</p>	<p><b>2</b></p>  <p>M6x20</p>	<p><b>3</b></p>  <p>M8x25</p>	<p><b>4</b></p>  <p>x2 Ø6</p>	<p><b>5</b></p>  <p>x8 Ø8</p>	<p><b>6</b></p>  <p>x2 M6</p>	<p>x4</p>
---	--	--	--	--	--	-----------

**SCREW FORCE:**  
M6 - 10 Nm; M8 - 30 Nm

